



CO₂ Fire Extinguishers

SERVICE AND MAINTENANCE MANUAL

2KG CO₂ AND 5KG CO₂ FIRE EXTINGUISHERS

Annual Service

1. Check that the extinguisher is within its test date by checking the manufacturers or the latest re-test date stamped on cylinder neck.
2. Check that the safety pin is in position. This should be removed to ensure that it moves freely and that the pin is in good condition. Refit and fit new safety seal.
3. Check the extinguisher body for damage or corrosion.
4. Check the label and instructions are legible.
5. Remove horn or hose/horn assembly. Note: - Some types of extinguishers are fitted with a grub screw. This must be loosened prior to removing horn.
6. Ensure that the horns, swivel arms and hose are clear from obstruction.
7. Check the weight of the extinguisher against the gross weight stamped on the cylinder neck. If there is a weight loss of more than 10% the extinguisher must be withdrawn from service for refilling.
8. If weight is correct, reassemble the extinguisher checking that all washers/seals are in good condition. If swivel arms are fitted, ensure they have sufficient friction to enable them to remain in the operating position without external support.
9. Record the date, weight and initial the service record label.

Recharging Procedure

Recharging is not practical in the field. CO₂ extinguishers that require filling or retesting should be taken to a filling depot or returned to the manufacturer.

Service and maintenance should be carried out by a qualified competent person in accordance with BS 5430 part 1 1990 for steel cylinders and part 3 for aluminium.





CO² FIRE EXTINGUISHERS

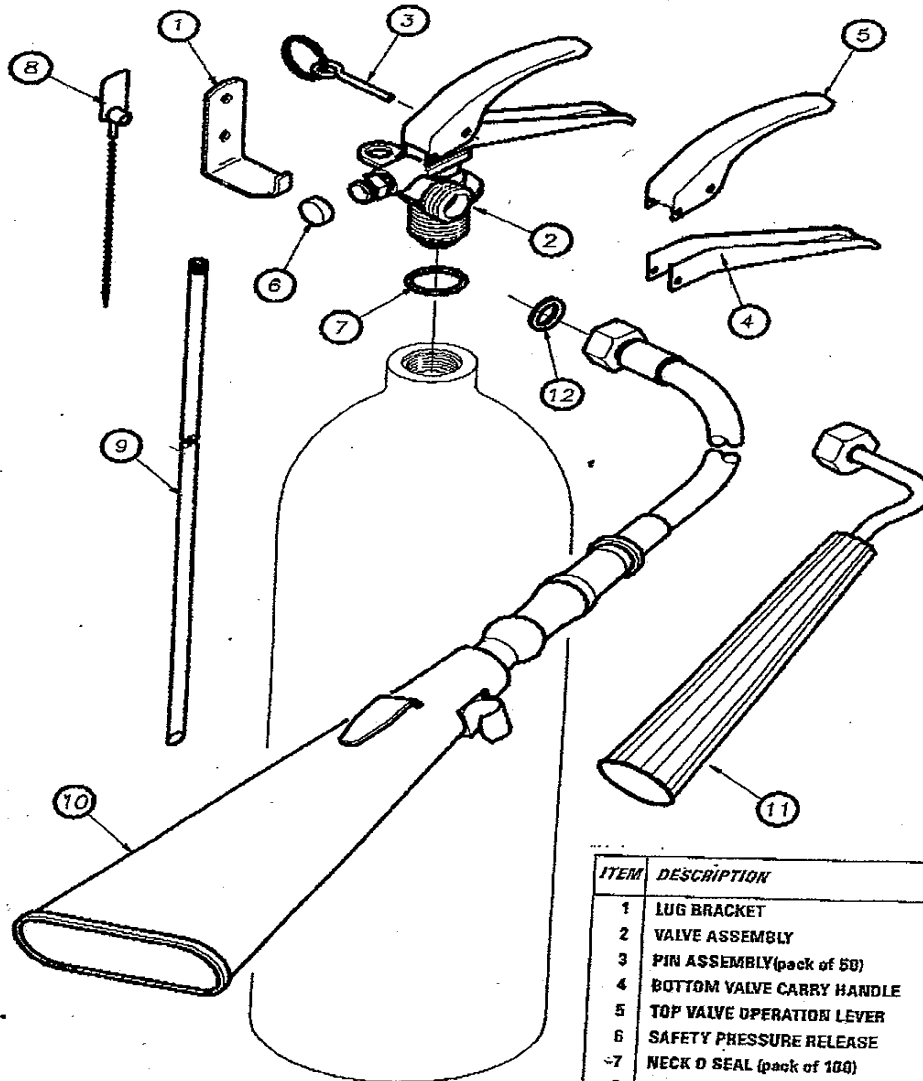

ITEM	DESCRIPTION
1	LUG BRACKET
2	VALVE ASSEMBLY
3	PIN ASSEMBLY(pack of 50)
4	BOTTOM VALVE CARRY HANDLE
5	TOP VALVE OPERATION LEVER
6	SAFETY PRESSURE RELEASE
7	NECK O SEAL (pack of 100)
8	PULL TIGHT SEAL (pack of 100)
9	SYPHON TUBE
10	HOSE & HORN
11	SWIVEL HORN
12	NYLON WASHER (pack of 50)
*13	T BRACKET
*14	WIRE TRANSPORT BRACKET

*DENOTES ITEMS NOT SHOWN